

ISSUED FOR BIDDING
5/31/24

ARCHITECT SEAL MUST BE IN RED INK
OWNER
Vision Academy Charter School



SITE SAFETY
It is the responsibility of the general contractor and/or the contractor listed as the licensed entity on the building permit per the municipality to ensure all site safety requirements are in place and followed, prior to, during, and after the commencement of the construction process until they are 100% complete and have received a building certificate of occupancy by governing agencies. They are also responsible for any unsafe conditions caused by or related to their sub-contractors' work. Plato Marinos, Architect LLC, and their professional consultants (associated with these documents) are not responsible for means and methods of construction, and/or site safety, including, but not limited to, OSHA construction safety requirements, standard construction, job site safety, job site safety training of workers, safe work site organization, safety direction and/or safety engineering of required safety elements. It is the sole responsibility of the licensed contractor to ensure that all site safety measures are in accordance with the governing authorities. Please refer to OSHA website (www.osha.gov) for additional training and information requirements for site safety compliance.

REV	DATE	DESCRIPTION

APPROVAL STAMP

EMERSON SCHOOL
GUARD HOUSE
Lansdowne, PA. 00000

EXISTING CONDITIONS

Project number	Project Number
Date	5/31/24
Drawn by	Author
Checked by	Checker

A100
Scale As indicated

DOOR HARDWARE SET 1

- GENERAL**
1. DOOR HUNG TO THE FRAME WITH HINGES
2. PANIC HARDWARE WITH LOCKSET
3. THRESHOLD NEEDED
4. SEALED AND PROTECTED DOOR (1HR RATED)
5. ELECTRIFIED DOOR
6. DOOR CLOSER
7. DOOR MUST BE SEALED

- SPECIFIC CONSIDERATIONS**
1. HEAVY FREQUENCY OF USE
2. EXPOSED TO WEATHER/CLIMATE
3. MATERIAL: TEMPERED GLASS AND ALUMINIUM

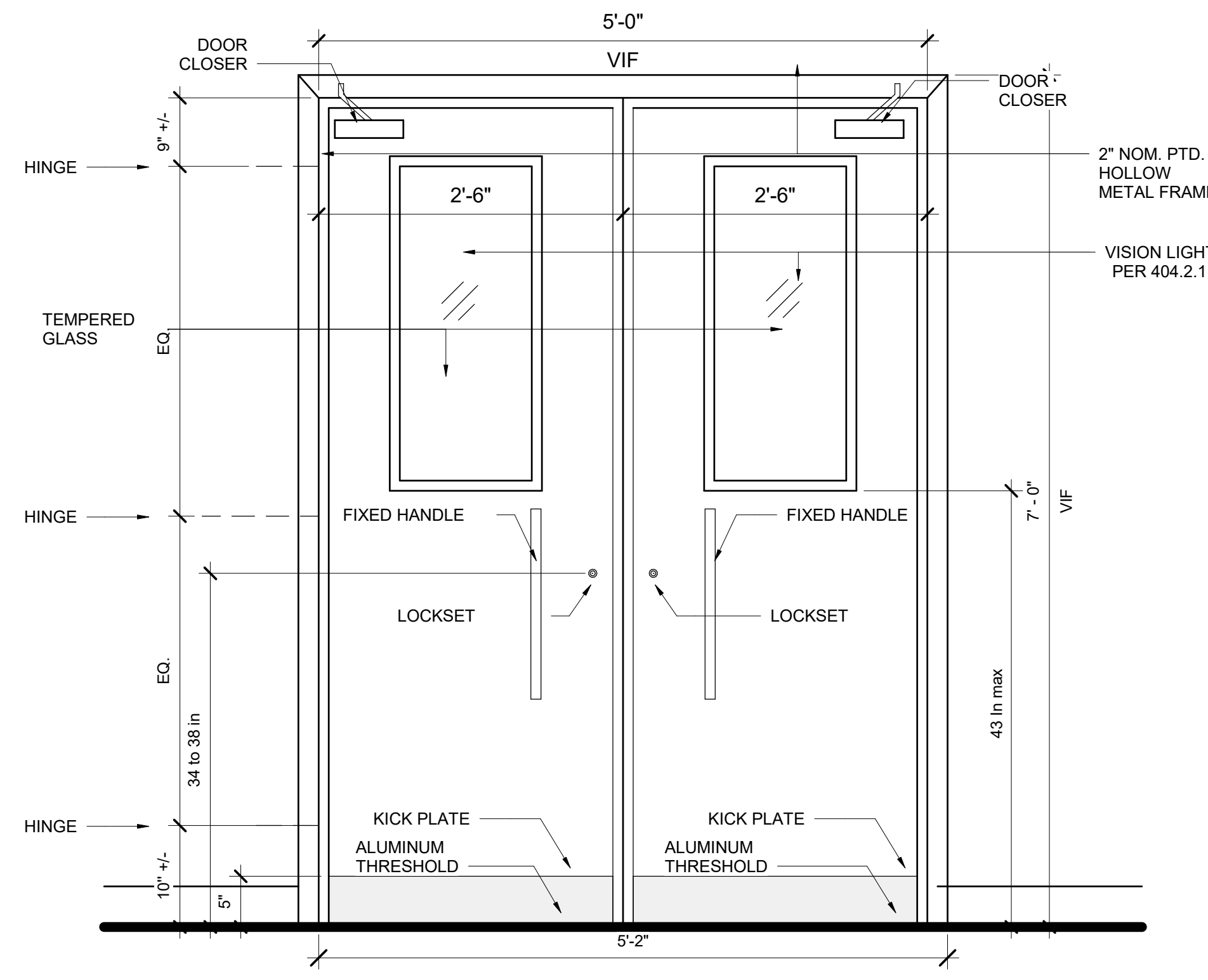

OUTSIDE THE BUILDING

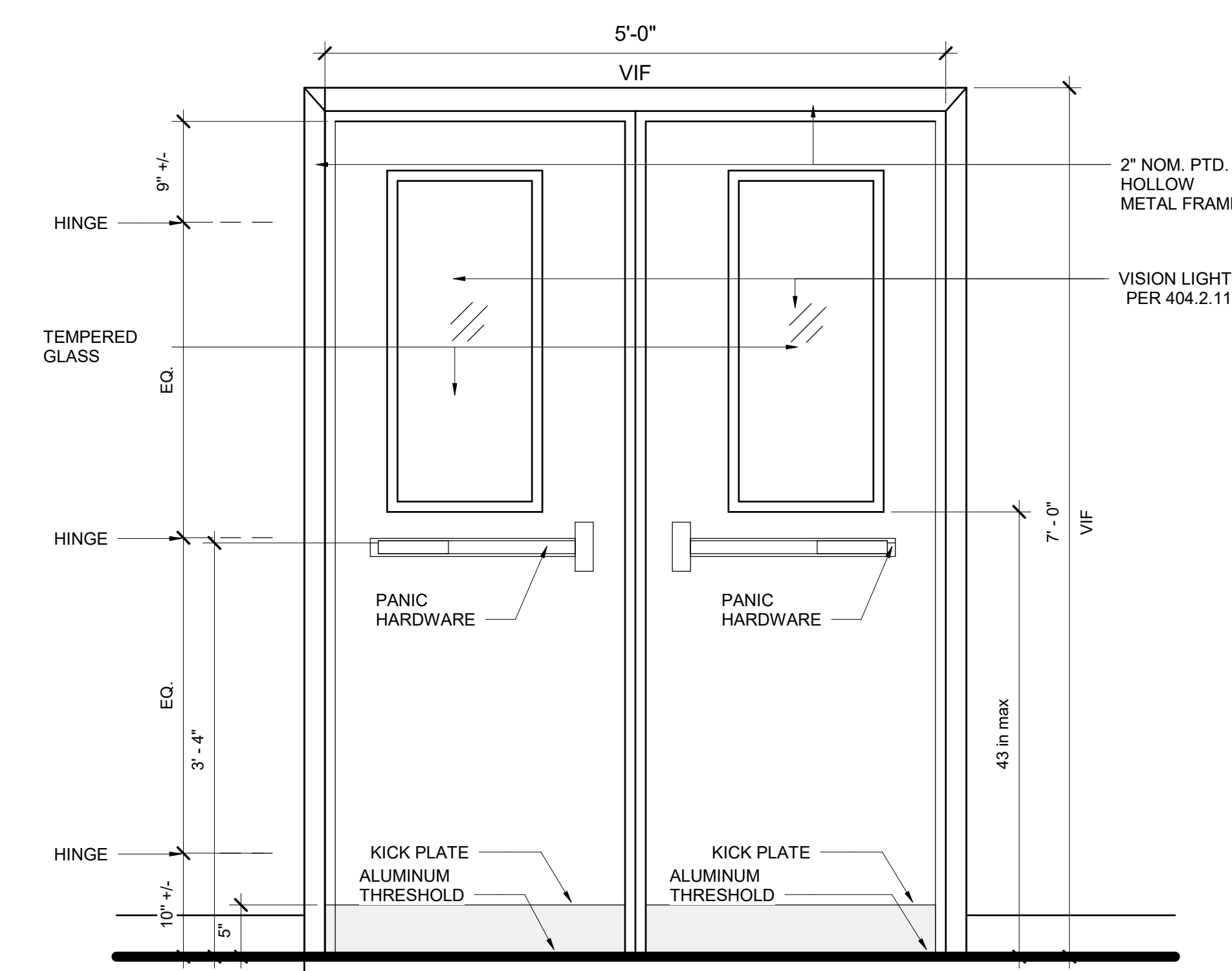

INSIDE THE BUILDING

DOOR HARDWARE SET 2

- GENERAL**
1. DOOR HUNG TO THE FRAME WITH HINGES
2. PANIC HARDWARE WITH LOCKSET
3. THRESHOLD NEEDED
4. NOT ELECTRIFIED DOOR
5. DOOR CLOSER

- SPECIFIC CONSIDERATIONS**
1. HEAVY FREQUENCY OF USE
2. MATERIAL: TEMPERED GLASS AND ALUMINIUM
3. VERIFY DOOR SING DIRECTION ON EXISTING CONDITIONS PLAN

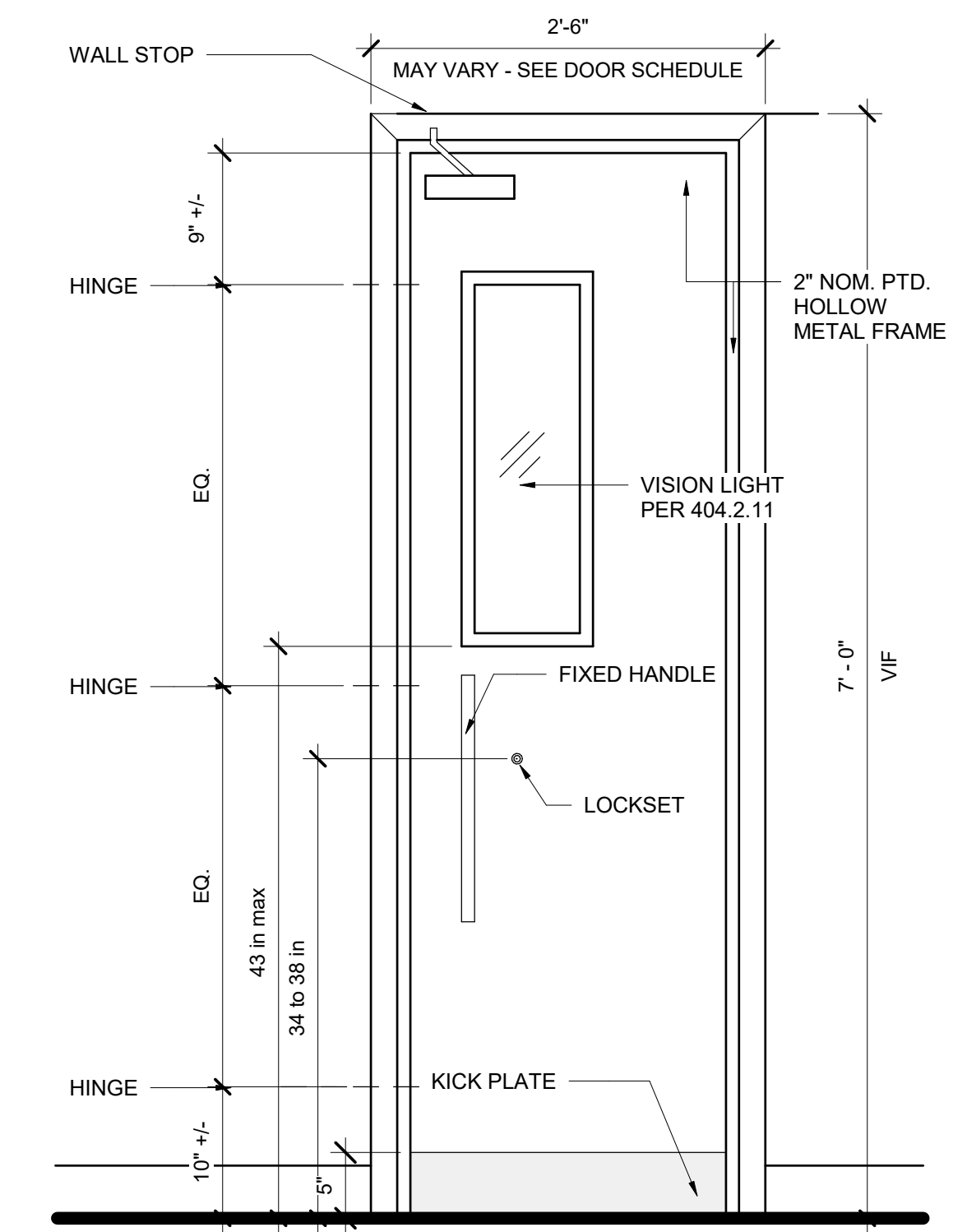

INSIDE THE GARAGE

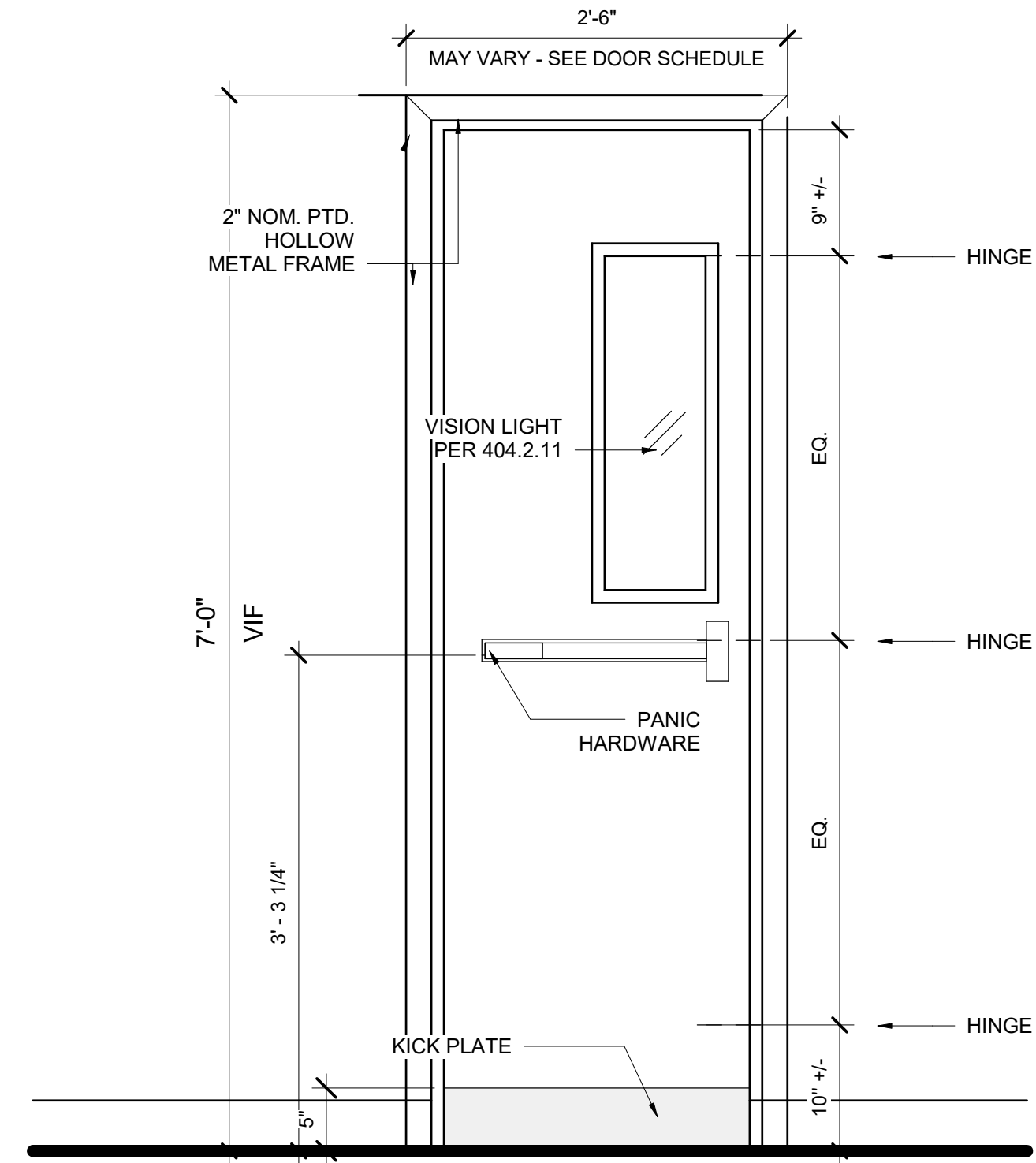

OUTSIDE THE GARAGE

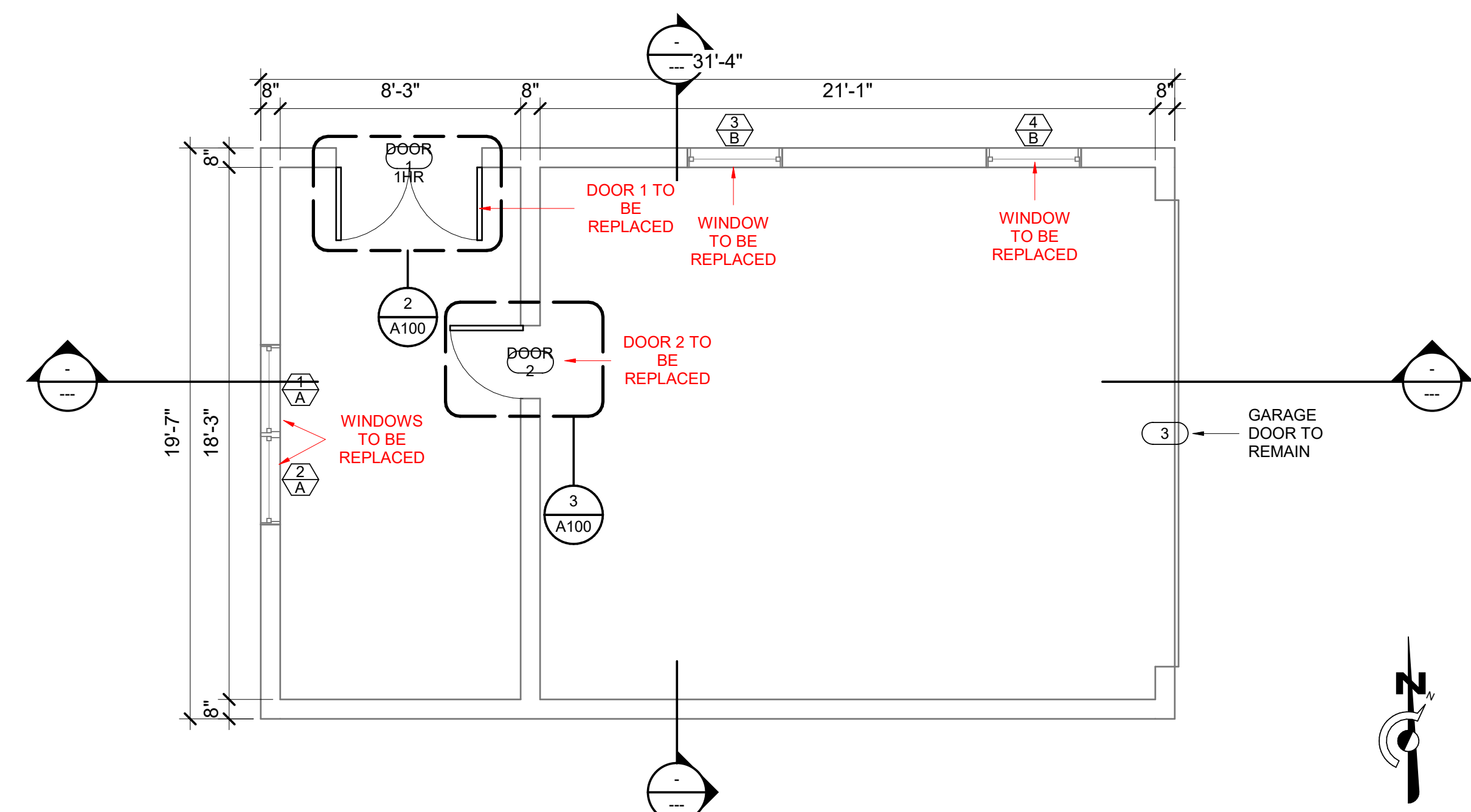

1 FIRST FLOOR(1)
A100 SCALE: 1/4" = 1'-0"

DOOR SCHEDULE 1

MARK	Level	PANEL		HARDWARE SET
		WIDTH	HEIGHT	
DOOR 2	FIRST FLOOR	2'-6"	7'-0"	2
DOOR 1	SIDEWALK	5'-0"	7'-0"	1

WINDOW SCHEDULE

NUMBER	TYPE	UNIT DIMENSIONS	
		HEIGHT	WIDTH
1	A	4'-5"	3'-1"
2	A	4'-5"	3'-1"
A: 2			
4	B	5'-0"	3'-3"
3	B	5'-0"	3'-3"
B: 2			
GRAND TOTAL: 4			

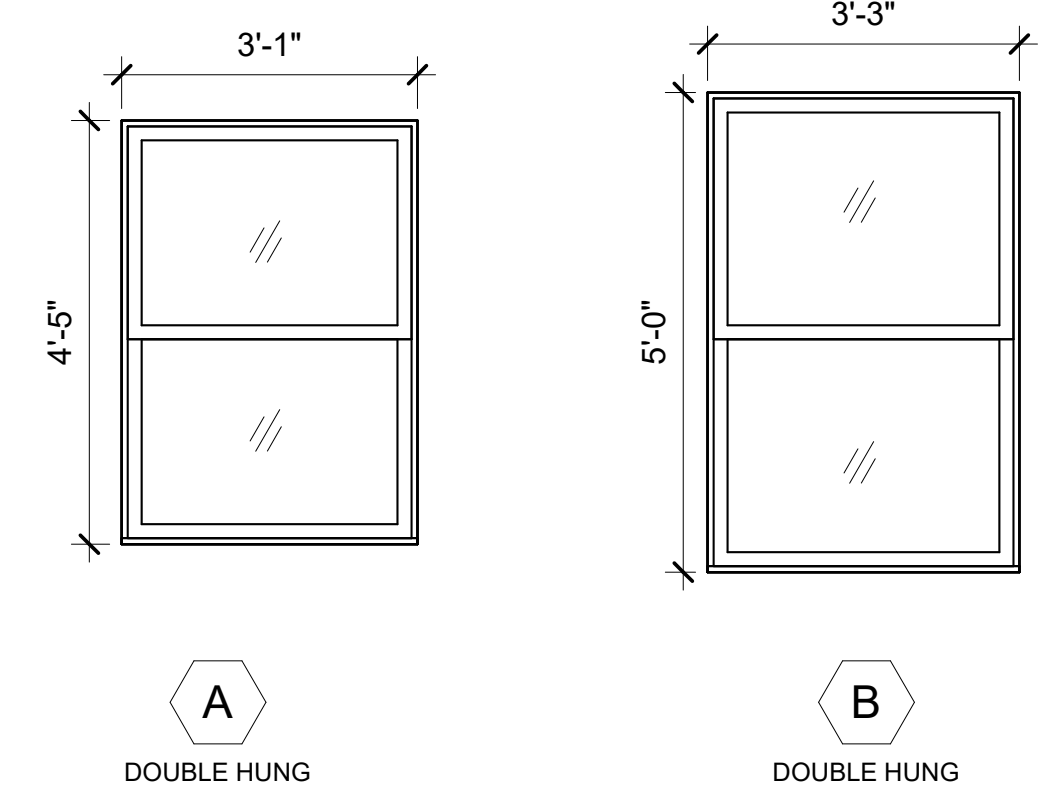

WINDOW TYPES
SCALE: 1/2" = 1'-0"

NOTE:
1. THE CONTRACTOR MUST VERIFY ALL DIMENSIONS IN THE FIELD PRIOR TO ORDERING AND INSTALLATION.
2. DOORS SLABS AND FRMASE TO BE REPLACED FOLLOWING THE PROPOSED HARDWARE SET

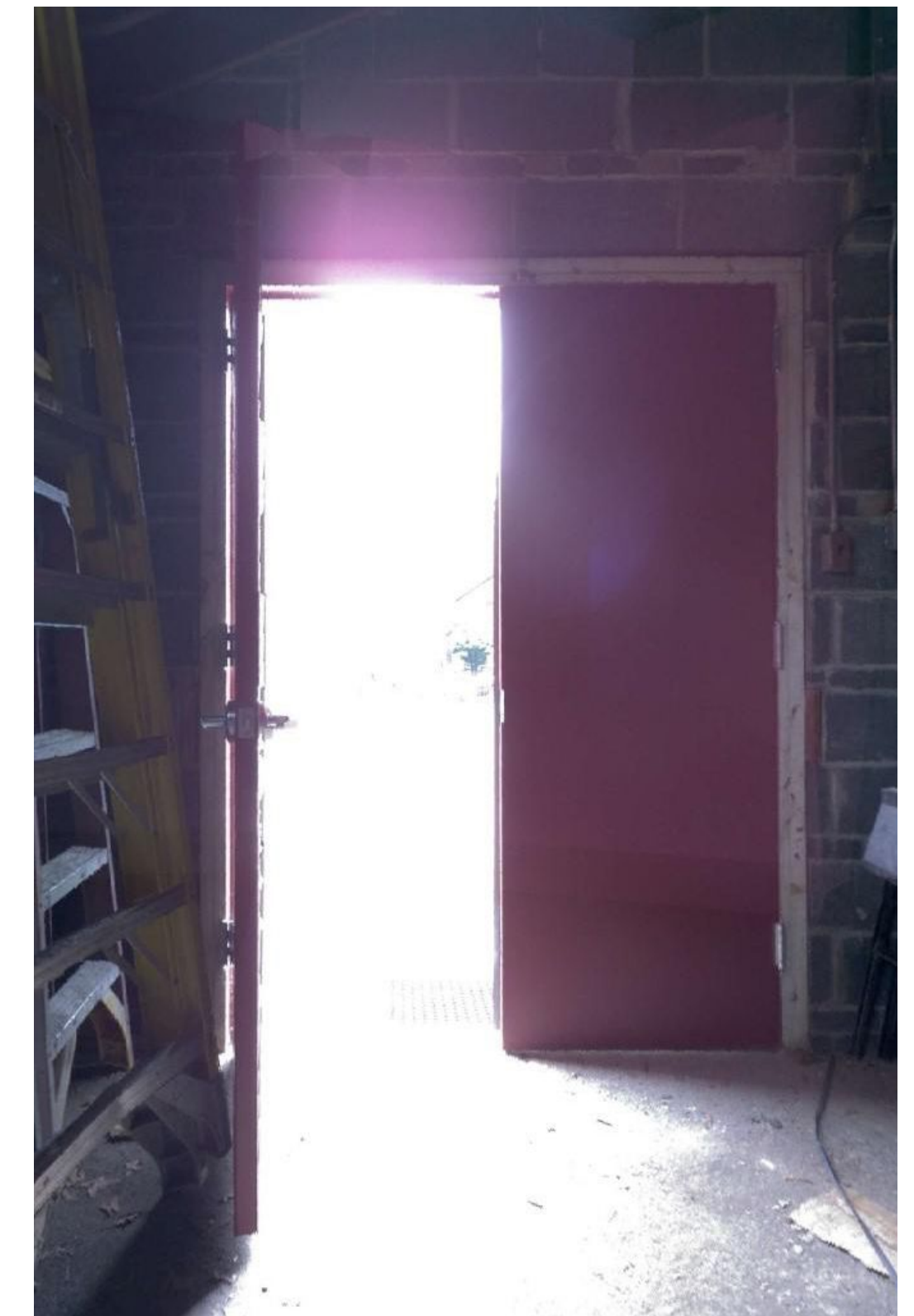

2 DOOR 1
A100 N.T.S.



3 DOOR 2
A100 N.T.S.